

Population

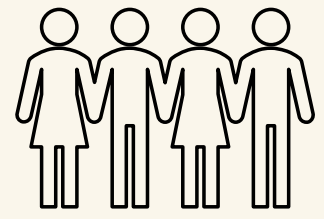

Facts about the Greater Essex Population

1.9M

Greater Essex has a population of roughly 1.9 million people...

13.4K

...which has grown by 13,400 per year over the last decade.

2.1M

By 2043, the population is predicted to increase to 2.1million.



+0.7%

The population has grown by 0.7% each year for the last decade.



74%

of the population increase is due to migration. 65% of which is domestic.

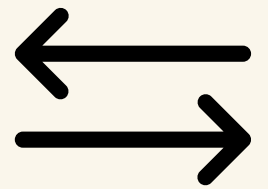

30%

of domestic migration comes from London.

309,000 people have long-term health conditions, with 1 in 3 consisting of people aged 70 and over.

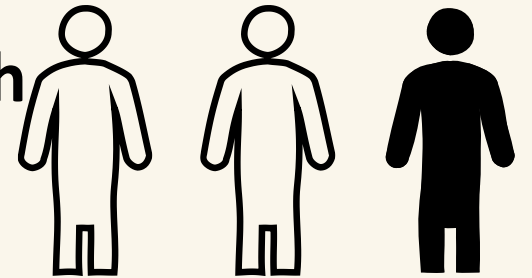

17%

of Greater Essex residents identified as a minority ethnic group in 2021 vs. 5.8% in 2001.

20%

of the population are aged 65+ (375,400). This is the age group with the fastest population growth.

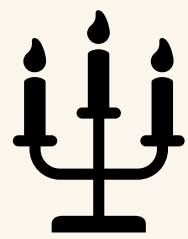

980K

of the population identify as members of a faith or religion.



5%

in 2021 had a language other than English and their 1st language vs. 3% in 2011.



34.5K

people aged 16+ identify as lesbian, gay, bisexual or another sexual orientation.



+1.4%

Our housing stock needs to grow by 1.4% each year to achieve mid-2030s target (c.197,000).



2.4 : 1

By 2043 the 'dependency ratio' is expected to fall to 2.4 compared to 3.2 in 2014.

*dependency ratio' refers to the proportion of working age people for every person of pensionable age.

Economy

Facts about the Greater Essex Economy

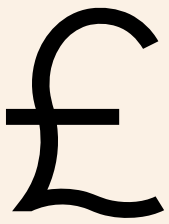

44.8BN

The economic output of Greater Essex per year is approx. £44.8 billion.



81K

Home to 81,000 businesses. The majority being small and medium enterprises.



700K+

of people are employees in Greater Essex.

+100K

of resident's travel to London for work and for the higher salaries.

40%

The incomes of residents who work in London are ~40% higher than those working in Essex.

Local productivity in Greater Essex remains low compared to neighbouring regions, due to a shortfall in local jobs and educational attainment.

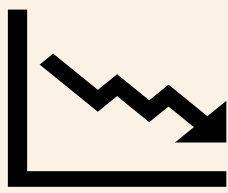

3.3%

The 3.3% claimant count unemployment rate is similar to the 2008 financial crisis.

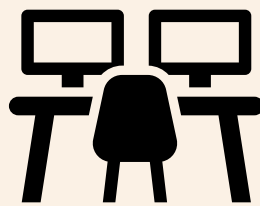

£34.8

Productivity (GVA per hour) for Greater Essex is £34.8. Below the South East average.



+30K

Number of high value 'professional jobs' needed to be in line with neighboring regions.

19.2%

of adults have no qualifications, which is above the national average.

314K

of working-age individuals are economically inactive due to long-term sickness in 2023. +16% vs. 2014.

The NEET (Not in Education, Employment, or Training) rates for 16–17 year olds are **3.4%** in Essex, **2.8%** in Thurrock, and **2.0%** in Southend-on-Sea.

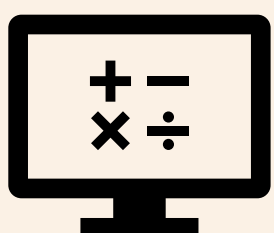

42% of jobs in Greater Essex are within sectors identified by national government as 'vulnerable' – meaning they are more sensitive to economic shocks.

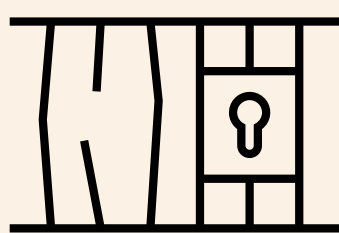

Opportunity to add **50,000** jobs to growth sectors such as, construction and retrofit, clean energy, advanced manufacturing, DigiTech, and life sciences.

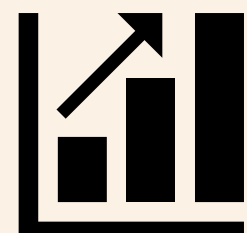

Inequality



Facts about Inequality in Greater Essex

10%

of the population live in areas ranked among the most deprived 20% in England.



188K

Greater Essex residents live in the most deprived 20% areas of England.

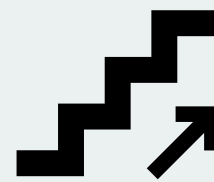

+43K

Rise of people living in most deprived 10% of areas from 2007 to 2019.



10.9%

of people living in 'left behind communities' in Essex claim unemployment benefits.

22%

of wards in Essex rank in the highest 10% nationally on key measures of community need.

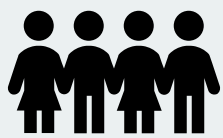

In 2019, of the $\approx 188,000$ people living in the most deprived 20% of England, 49,000 were children (27%).

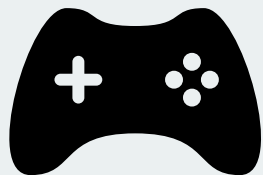
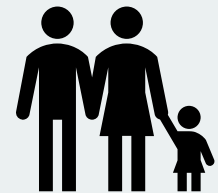

11%

of young people (16-24) are unemployed in Greater Essex.



$\approx 35K$

Pupils in Greater Essex are eligible for Free School Meals (FSM).



$\approx 44K$

Pupils in Greater Essex have been assessed as having Special Education Needs or Disabilities (SEND).

23%

FSM-eligible pupils are 23% less likely to be in sustained employment by age 27 compared peers and experience a gap in earnings at age 30.

+1%

The percentage of NEET (Not in Education, Employment or Training) 16-17-year-olds in Essex increased from 2.4% in 2019 to 3.4% in 2023.

205,490

households are on relative low incomes (under £30k per year) - 27.7% of all households (2023).

243,000

households have a discretionary income of less than £125 per month (32% of households).

Local analysis suggests that those who are most vulnerable to pressures on their income are likely to be:

- Living in households with children (particularly single parent households).
- Older women living alone (aged 65+).
- Households from black and minority ethnic backgrounds.

Health & Wellbeing





Facts about Health & Wellbeing in Greater Essex



Health outcomes vary significantly across Greater Essex, with life expectancy differences of up to 17 years for males and 14 years for females between locations.

Life Expectancy in Greater Essex

	Essex	Southend-on-Sea	Thurrock
	79.8	78.0	77.1
	83.5	82.4	82.0

64%

Adult obesity levels have surpassed those in England and the East of England.

<626

Hospital related admissions due to alcohol which is less than the national average.

9.25K

School pupils in 2022/23 suffered with social, emotional, and mental health needs.



There are continuing health inequalities felt across Greater Essex - with those living in more deprived areas facing worse health outcomes.

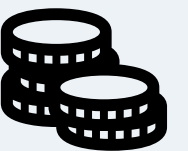

Greater Essex



0.8% decline in full-time GPs between Oct '21 and Apr '22 in Greater Essex.



In the last 15 years, the percentage of overweight and obese 10-11-year-olds has risen by between 4.5% to 13.3% across Greater Essex.



Life expectancy in Greater Essex increased by between 1.7% to 3.1% from 2001-2003 and 2020-2022.

Essex



+13.3% in the number of children aged 10/11 who are 'overweight & obese' vs. 15 years ago.



68% of Essex residents claim to be 'active' vs. England at 63%. However, this is significantly lower in more deprived areas (61%).



Those living in deprived areas are more likely to experience stress and anxiety, and low levels of life satisfaction.

Southend-on-Sea



Suicide rates have risen by 10% over the last decade (2010/12-2020/22) to 8.5 per 100,000. But remain lower than figures 20 years ago.



Smoking prevalence has declined by 6% pts. A slightly greater rate vs. the Greater Essex average (5%).

Thurrock



24% of children aged 10/11 were classified as 'overweight & obese' in 2022/23.



Suicide rates have fallen by 31% over the last decade (2010/12-2020/22) to 5.9 per 100,000.

Environment

Facts about the Environment in Greater Essex



+1°C

Global temperatures have risen by 1°C above pre-industrial levels and are projected to reach 1.5°C between 2030 and 2052.



-47%

Reduction in summer rainfall in UK by 2070. +35% in the winter.

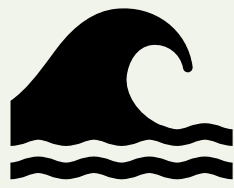

18.5MM

UK sea levels have risen by 18.5mm since 1900's. 60% occurring in the last 60 years.

14%

of Greater Essex is covered by Areas of particular importance for biodiversity (APIBs), such as natural conservation sites.

350-400 miles

of coastline, the 2nd longest in the UK. High risk of coastal flooding and erosion. Surface water flooding remains the greatest risk in GE.

As a county, our carbon emissions need to be reduced from **8.09 MtCO₂e** in 2020 to **3.19 MtCO₂e** by 2030 to be on track to reach the net zero target.



5.52 TONNES

of CO₂e was emitted per Essex resident in 2020; lower than the UK but short of the 5.3 tonnes target.

Of UK greenhouse gas emissions...



Transport accounts for...

28%

- Greater Essex has the highest estimated traffic in East of England: **10.9 bn** vehicle miles.
- Bus and rail usage lower vs. pre-Covid.
- 2.5%** EV uptake in 2022.



Electricity supply accounts for...

14%

- 73%** reduction across the UK since 1990.
- 48.5%** of UK electricity used in 2022 was from zero-carbon sources.
- 28.6%** of UK's energy generation was from wind power.



Waste accounts for...

5%

- Essex County Council collects **≈700,000 tonnes** of waste per year.
- 52%** of waste recycled in 20/21 vs. **21%** in 00/01.
- 947 KG** of waste produced per household 22/23.

On average the county consumes larger volumes of water per person than most of England. Only three fifths of the drinking water consumed here comes from the county itself.

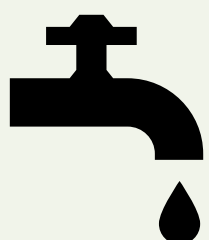

From 2025, developers must comply with the Future Homes Standard, requiring new homes to produce **75-80%** less carbon emissions through higher energy efficiency and low-carbon heating systems like heat pumps.

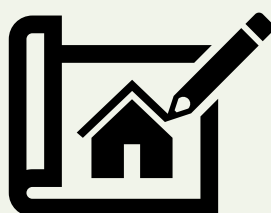

Concern over climate change among Essex residents, and the UK, has declined:

- 36%** feel extremely / very worried about climate change in '23 vs. **49%** in '22.
- 56%** feel personally responsible in '23, vs. **64%** in '22.

